

Memory Care

Our community presents a just-like-home atmosphere, emphasizing the most important component of living arrangements – safety. Our community is designed specifically for those with memory care needs, providing not only an uncomplicated and easy-to-manuever physical floor plan with cozy décor, but also a safe haven for your loved one. All residences are strategically designed for comfort, and can be personalized with items that are familiar and comforting.

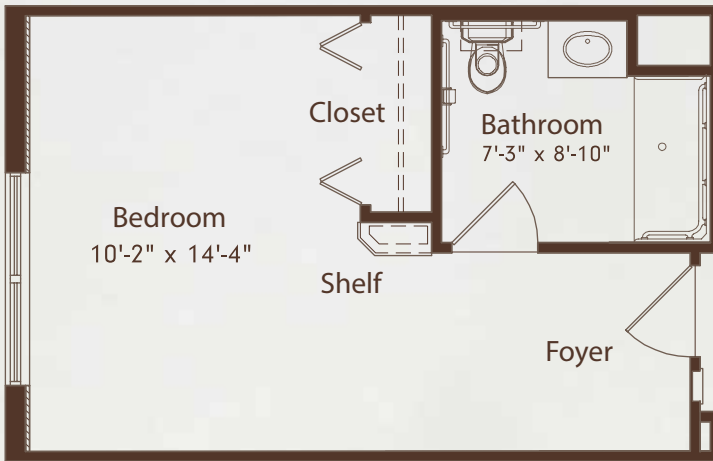

FRANKLIN | Studio | 345 Sq. Ft.



IRVING | Studio | 328 Sq. Ft.

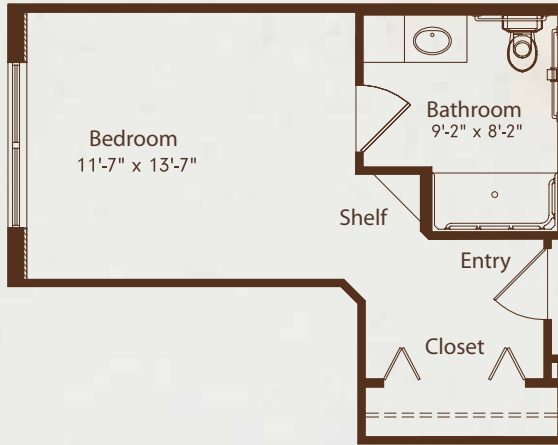

ALCOTT | Studio | 270 Sq. Ft.

